

一樓至五樓平面圖

1st to 5th Floor Plan

樓面負重：一樓 300 磅/平方呎
二樓至五樓 200 磅/平方呎

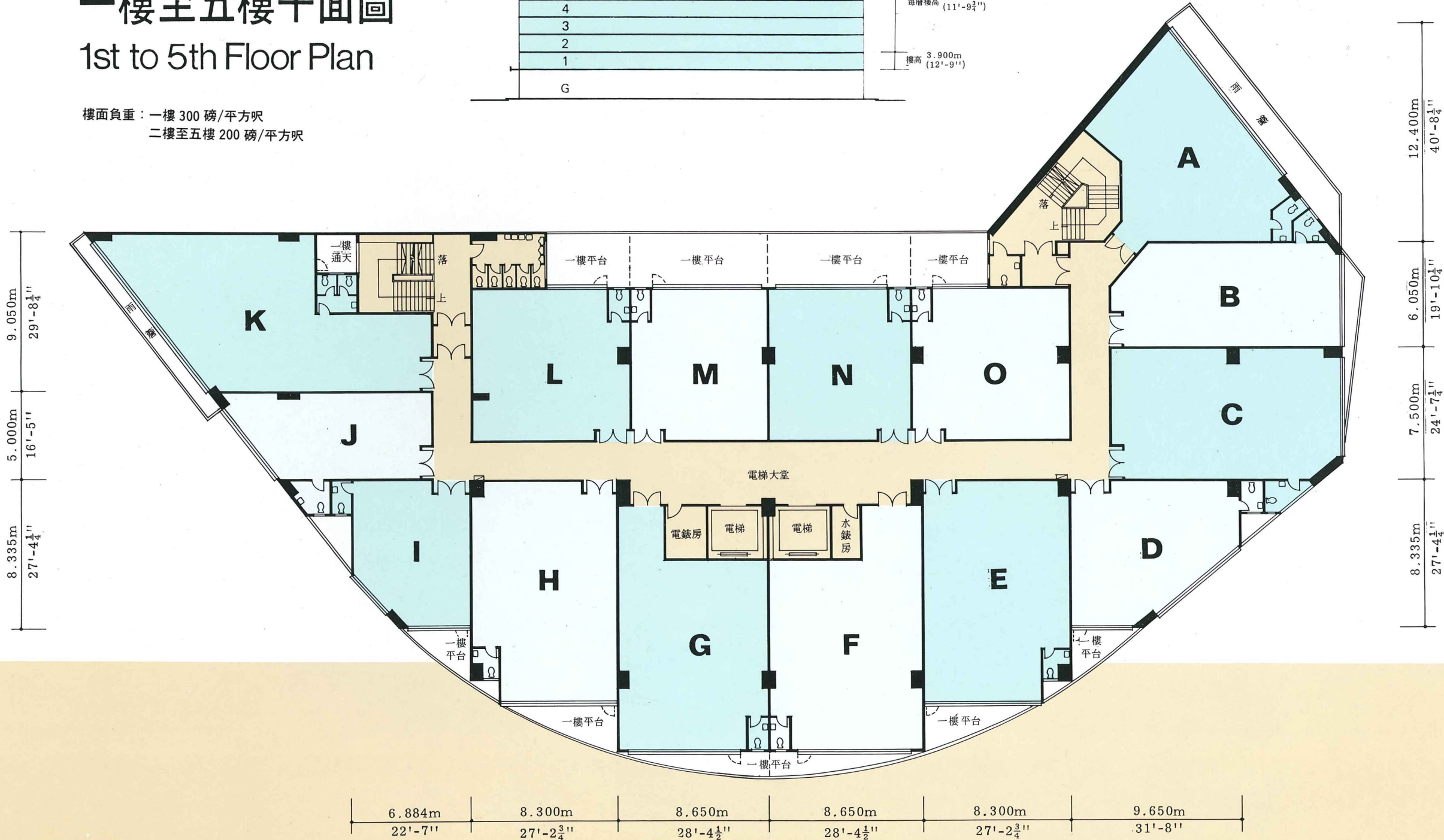
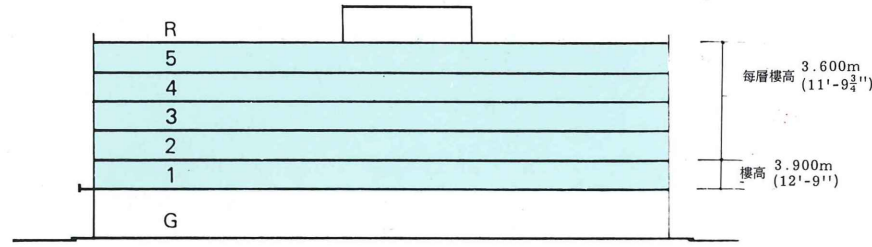

所有圖則及長度只供參考用，詳細圖則以政府有關部門最後批准之圖則為準。 All floor plans and measurements are for reference only and are subject to the final plans approved by the Building Authority.